

## 1.2. Types and Features of the Cross-Roller Ring

### ● Model RB (Separable Outer Ring Type for Inner Ring Rotation)

The outer ring is separable while the inner ring is integrated with the main body. This model is used in locations where the rotational accuracy of the inner ring is required.

Standard Type



Model RB

### ● Model RE (Separable Inner Ring Type for Outer Ring Rotation)

The inner ring is separable while the outer ring is integrated with the main body. This model is used in locations where the rotational accuracy of the outer ring is required.

Standard Type



Model RE

### ● Model RA (Separable Outer Ring Type for Inner Ring Rotation)

Model RA is a lightweight, compact type with thinnest possible inner and outer rings. It is used in locations where the rotational accuracy of the inner ring is required.

Thin Type



Model RA

### ●Model RA-C (Single-Split Type)

The major dimensions are the same as that of model RA. Since the outer ring is split as one point, this model is optimal for locations where the rigidity and accuracy of both the inner and outer rings are required.

Thin Type



Model RA-C

### ●Integrated Inner/Outer Ring Type (Special Type)

It achieves stable starting torque and eliminates a presser flange and a housing.

For inquiries about manufacturing this type, contact **THK**.

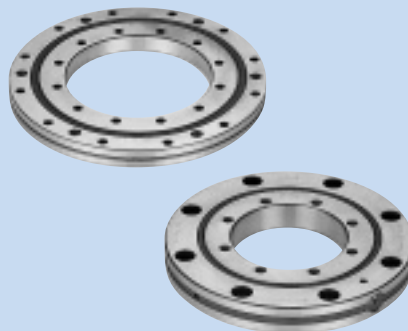

### ●USP-Grade Series of Models RB and RE

The rotation accuracy of the USP-Grade Series achieves the ultra-super-precision grade that surpasses the world's highest accuracy standards such as JIS Class 2, ISO Class 2, DIN P2 and AFBMA ABEC9.

